

Silca
SYSTEM



Buzon

SILCA SYSTEM

OVER-MEMBRANE
DIRECT ON BUZON PEDESTAL

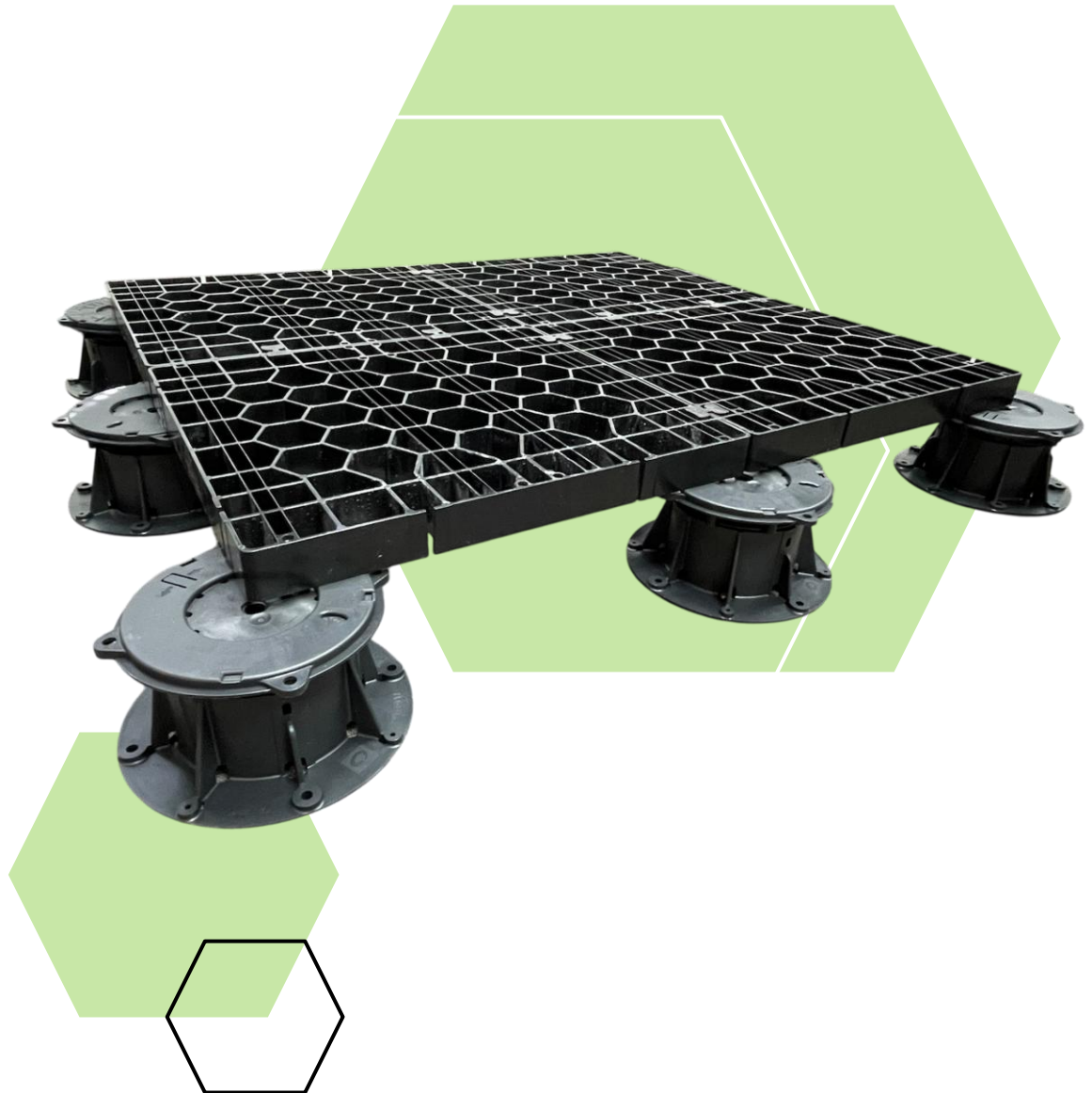

INSIDE THIS ISSUE

PG. 2

Key Benefits and Technical Highlights

PG. 3

Range of pedestal heights available.

PG. 4

Notes and contact

OVER-MEMBRANE

SILCA SYSTEM GRATES INSTALLED ON ADJUSTABLE PEDESTALS

DIRECT ON BUZON PEDESTAL

Silca System Grates install directly onto adjustable pedestals and are now fully optimised for over-membrane applications when paired with the Buzon Adjustable Pedestal DPH range.

Engineered for demanding residential and commercial environments, the system provides a rigid, ventilated, and permeable support platform for tiles, natural stone, pavers, or artificial turf. The combined Silca + Buzon solution meets E2/AS1 requirements for over-membrane installations, including level-entry thresholds, while offering a robust and cost-effective alternative to traditional structural substrates.





KEY BENEFITS:

DIRECT INSTALLATION ON ADJUSTABLE PEDESTALS

Silca System Grates installed directly with the Buzon DPH Adjustable Pedestal Range, creating a fully supported, ventilated, and permeable platform for exterior surfaces over membrane or slab. Each pedestal supports the corners of adjoining Grates, delivering consistent performance, simplified levelling, and reliable compliance across the deck structure.

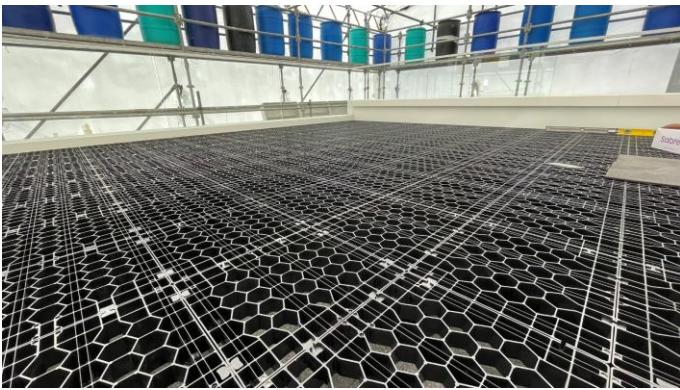
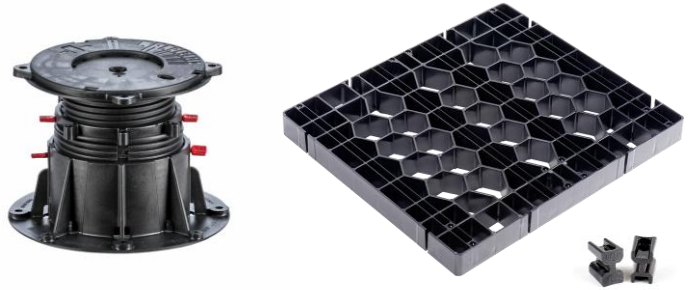
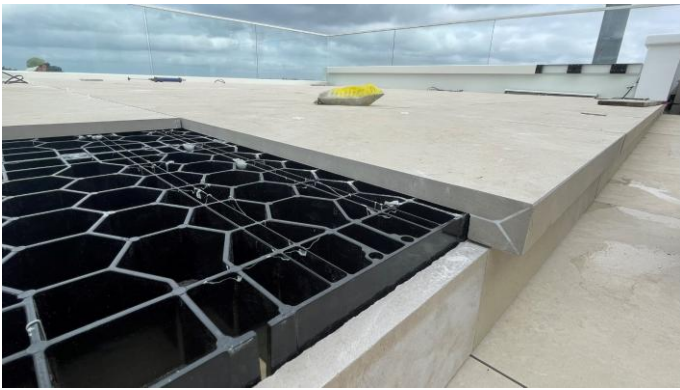

SUPPORT FOR A RANGE OF SURFACES

The system provides a rigid, structurally compliant substrate for non-structural finishes including natural stone, terrazzo, porcelain tiles, concrete pavers, or artificial turf. The interlocked Grates distribute loads evenly across the surrounding element, preventing cracking or failure while maintaining full design flexibility and access zones where required.



FLEXIBLE PACKAGE OPTIONS

Supply packages can be tailored to suit residential or commercial projects, including complex membrane applications, threshold transitions, and designated access zones for services, maintenance or drainage.



TECHNICAL HIGHLIGHTS:

DURABILITY & LOAD-BEARING CAPACITY

Silca System Grates are engineered and tested for high-traffic commercial and residential environments. Load performance includes 5,000 kg spanned testing at 400 mm centres and 68,000 kg compression testing, confirming significant performance margin above AS/NZS 1170.1 live-load requirements. When combined with Buzon DPH pedestals (typical 11.5 kN capacity), the system achieves uniform load capacities exceeding standard pedestrian and tile surface requirements.

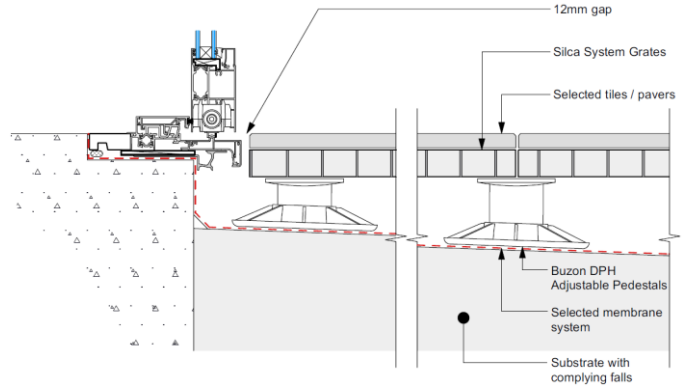

Further data and specification, refer to our Technical Data Sheet TDS

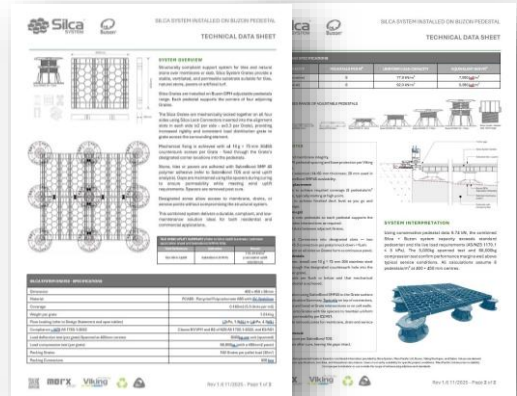

SUSTAINABILITY & COMPLIANCE

Manufactured in New Zealand from 100% recycled PCABS, UV-stabilised for exterior durability, and classified as a green-build product. The combined Silca + Buzon system meets structural and durability requirements under B1/VM1, B2 (NZS AS 1720.1:2022), and E2/AS1 for permeable surfaces, including low-threshold level-entry specification. The system is mechanically locked, screwed, and adhered to meet performance expectations in wind uplift and long-term service conditions.

NZ-MADE USING 100% RECYCLED MATERIALS

All Silca System Grates and connectors are produced locally using recycled engineered polymers, reducing environmental impact while delivering high dimensional stability, low maintenance, and long service life.



Our DPH-series

■ Fixed ■ Adjustable

DPH-series without integrated slope corrector



DPH-series with integrated slope corrector



Integrated **slope corrector**

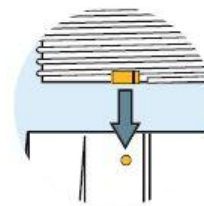

An **unscrewing safety system** preventing each element from detaching **at the maximum height reached**



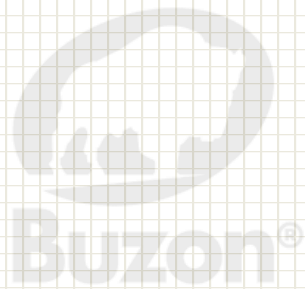

Further technical info TDS and E2/AS1 extract can be found here: www.silcasystem.co.nz/resources/

Silca System

Website: www.silcasystem.co.nz

Email: info@silcasystem.co.nz

